

Lite-Deck Installation Bulletin - April, 2006

Basic assembly steps to install Lite-Deck Perimeter Bracing, using steel C-channels or studs.

Lite-Deck Perimeter Bracing (12" to 16" apart)

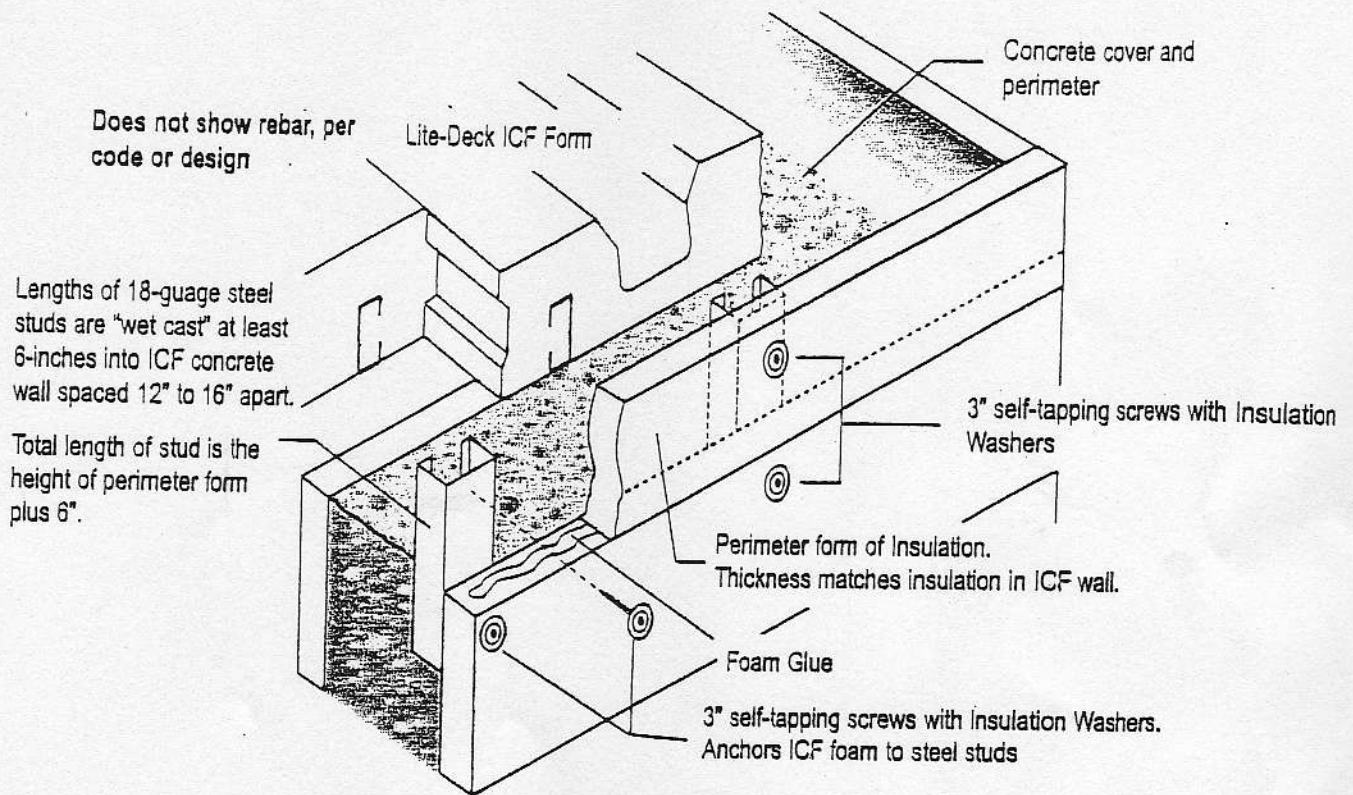

Lite-Deck Perimeter Bracing (Over 16" apart)

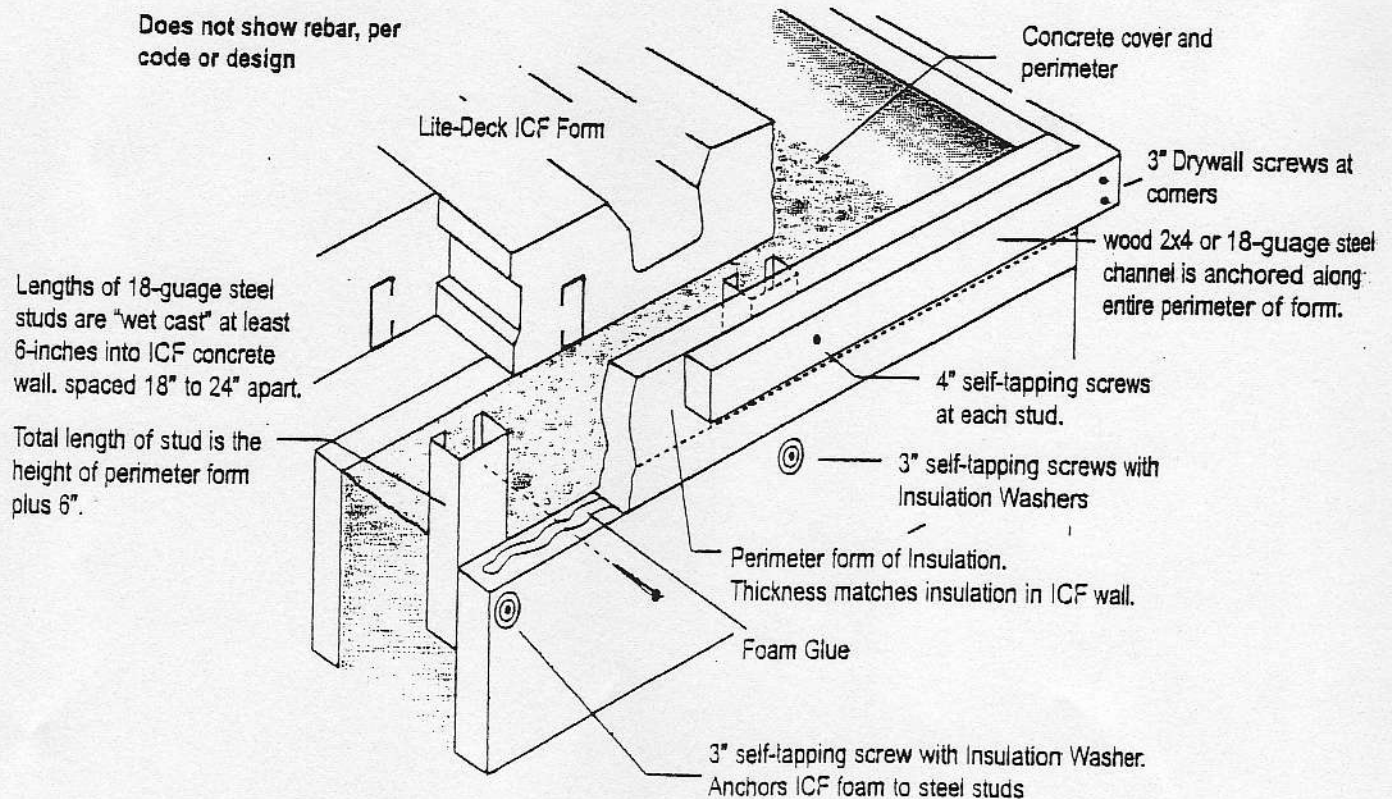

Lite-Form Technologies - P.O. Box 774 - Sioux City, IA 51102

Phone 800-551-3313 (U.S. and Canada) or 402-241-4402 - FAX: 402-241-4435

Website: www.litedeck.com - e-mail: general@liteform.com